

Wheel Assembly Information

As we strive to improve our machines, sometimes information within the manuals can be outdated. If the information in your manual is not consistent with the machine you've received please inform us.

Components

- A** Wheels x 2
- B** Axle x 2
- C** Large Washer x 4
- D** Small Washer x 4
- E** Split Pin x 2
- F** R-Clip x 2

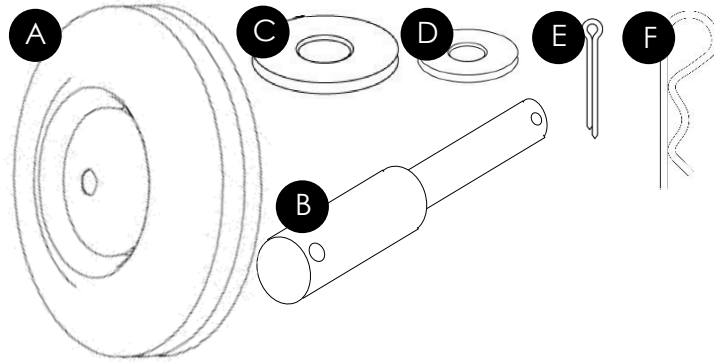

Assembly

- 1 Place 1 **Split Pin (E)** through the thicker side of an **Axle (B)** and open the wings of the pin as shown below. Then place 1 **Larger Washer (C)** on the Axle. Pass this through a **Wheel (A)** on side with the lower dish.
- 2 On the other side of the Wheel, place 1 **Larger Washer (C)** then 1 **Small Washer (D)**. Pass the axle through both the holes from the outside.

THE LARGER DISHED SIDE MUST FACE TOWARD THE MACHINE AS SHOWN

- 3 Place 1 **Small Washer (D)** on the end of Axle, and pass 1 **R-Clip (F)** to secure.
- 4 Repeat on the other side.

